

(4) 1/2-13 UNC X .75 DP. ZINC PLATED STEEL INSERTS, EQUALLY SPACED ON A ϕ 5.00 B.C.
(MOUNTING INSERTS ARE COMMON WITH INTERNAL GROUND SHIELD)

ϕ 6.00 O.D. X ϕ 3.75 I.D. X .09 DP GASKET RETAINING GROOVE

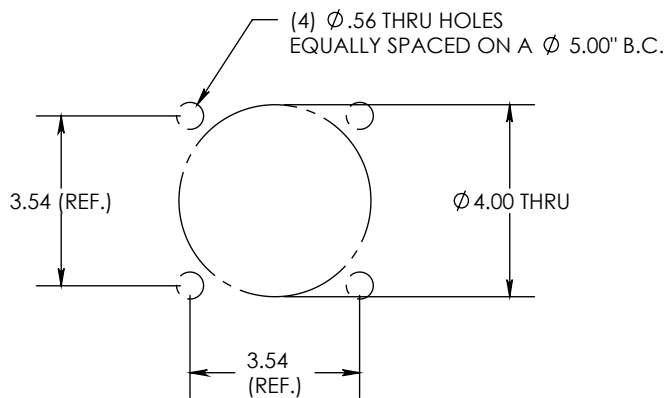

RECOMMENDED MOUNTING DETAIL

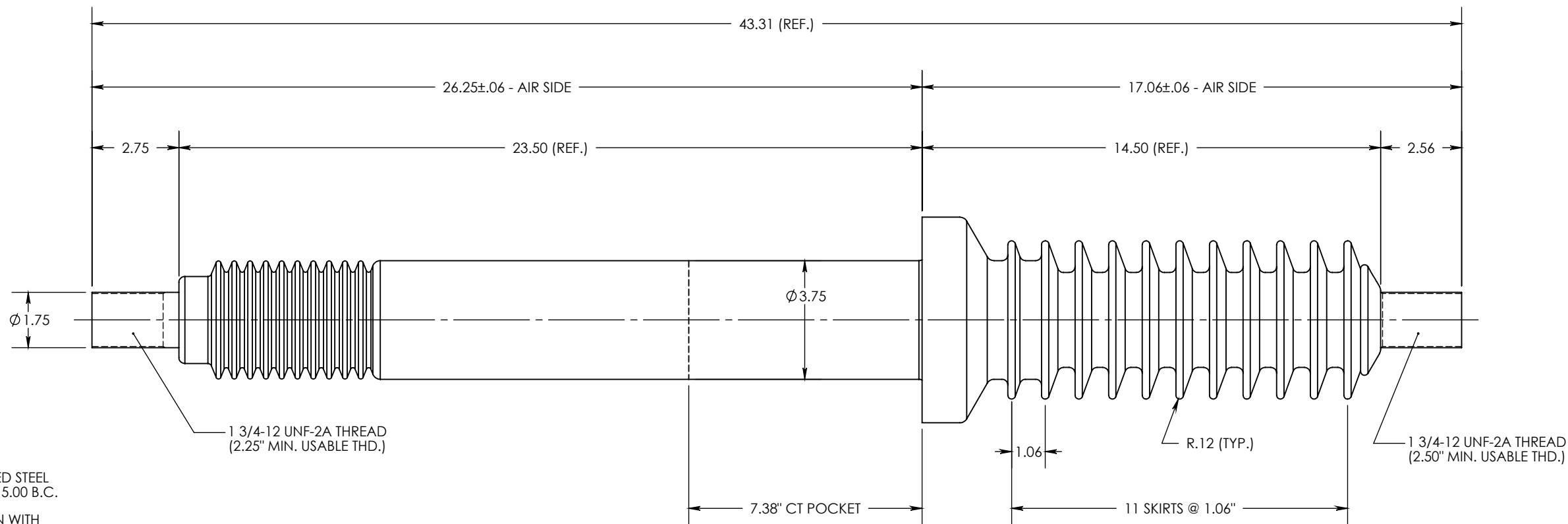

NOTES:

1. ALL CONTACT SURFACES TO BE CLEAN & FREE FROM FLASH

MATERIAL:

- 1. E07 - CYCLOALIPHATIC EPOXY (U.V. EXPOSED), COLOR: GREY
- 2. HD ETP COPPER, C11000, TIN PLATED
- 3. ANODIZED ALUMINUM NAMEPLATE

SPECIFICATIONS:

- 1. MANUFACTURED IN ACCORDANCE WITH IEC 137-1995, CAN/CSA-C88.1-96, IEEE C57.19.01-1991
- 2. RATED VOLTAGE 38kV
- 3. POWER FREQUENCY WITHSTAND 80kV
- 4. BASIC IMPULSE LEVEL 200 kV
- 5. NOMINAL CURRENT RATING 2000 AMPS
- 6. CREEP DISTANCE 33"/838 mm (24 mm/kV)
- 7. TEMPERATURE CLASSIFICATION -50°C TO +105°C
- 8. APPROXIMATE WEIGHT 58 LBS



H-J INTERNATIONAL, INC.
3010 HIGH RIDGE BLVD, HIGH RIDGE, MO. 63049 USA
PHONE 1-636-677-3421 FAX 1-636-376-1915

POWER APPARATUS BUSHING
38kV/2000A

PROPRIETARY AND CONFIDENTIAL THE INFORMATION CONTAINED IN THIS DRAWING IS THE SOLE PROPERTY OF H-J INTERNATIONAL, INC. ANY REPRODUCTION IN PART OR AS A WHOLE WITHOUT THE WRITTEN PERMISSION OF H-J INTERNATIONAL, INC. IS STRICTLY PROHIBITED.	TOLERANCES (EXCEPT AS NOTED)
	ONE PLACE MM ± 1.50 TWO PLACE MM ± 0.75 TWO PLACE DEC. $\pm .060$ THREE PLACE DEC. $\pm .030$ FRACTIONS $\pm 1/16"$ ANGLES 2°
BREAK ALL SHARPS UNLESS OTHERWISE NOTED	

APPROVED BY	DB	DATE	11/17/2004
CHECKED BY	RM	DATE	11/17/2004
DRAWN BY	DB	DATE	11/17/2004
TOOL NO.	T20-500-8		
PRODUCT GRP.	2000 SERIES		

MATERIAL				
DRAWING NO.	20-500-800			
SCALE	1:4	SIZE	B	REV. 0
SHEET	1	OF	1	